

Ref.F.No.42-63/10-Works/

Dated: 02/8/2010



**PROCUREMENT OF CIVIL WORKS
UNDER
NATIONAL SHOPPING PROCEDURES**

(For Works valued less than equivalent of \$ 50,000 each)

**INVITATION FOR QUOTATIONS FOR CONSTRUCTION OF
CIVIL WORKS UNDER SHOPPING PROCEDURES**

To

Dear Sirs,

Sub : INVITATION FOR QUOTATIONS FOR
CONSTRUCTION/RENOVATION OF CIVIL/ELECTRICAL/LAN CABLING
WORKS FOR CREATION OF A FACILITY FOR A COMPUTER CENTRE FOR
PROPOSED ASRB ONLINE EXAM HALL UNDER NAIP AT DMAPR, BORIAVI
- reg.

1. You are invited to submit your most competitive quotation for the following works:-

Brief Description of Works	Approximate value of the Works (Rs.)	Period of Completion
AS PER LIST ATTACHED Page No: 19-39		Within 45 days from the date of award of work.

2. Government of India has received a credit from the International Development Association (IDA) in various currencies equivalent to US\$ _____ towards the cost of the _____ Project and intends to apply part of the proceeds of this credit to eligible payments under the contract for which this invitation for quotations is issued.
- 3¹. The NAIP Project in GUJARAT state is being implemented by ICAR/DMAPR, which is an autonomous society registered under the Societies Registration Act.
4. To assist you in the preparation of your quotation, we are enclosing the following :
- i. Layout Drawings of the works;
 - ii. Structural Details;
 - iii. Detailed Bill of Quantities, with estimated rates and prices;
 - iv. Technical Specifications;
 - v. Instructions to Bidders (in two sections).

¹ Delete if inapplicable

- vi. Draft Contract Agreement format which will be used for finalizing the agreement for this Contract.
5. You are requested to provide your offer latest by **14.00 hrs. on 11.08.2010**
6. Quotations will be opened in the presence of Bidders or their representatives who choose to attend at **14.30 Hrs on 11.08.2010 in the office of DMAPR, BORIAVI, ANAND (GUJARAT)**
7. We look forward to receiving your quotations and thank you for your interest in this project.

Name: THE DIRECTOR

Address: DMAPR, BORIAVI-387 310
ANAND (GUJARAT)

Tel. No: 02692-271605

Fax No. 02692-271601

Instructions to Bidders

SECTION - A

1. Scope of Works

The DIRECTOR, DMAPR, BORIAVI invites quotations for the construction of works as detailed in the table given below:

Brief Description of the Works	Approximate value of Works (Rs.)	Period of Completion
AS PER LIST ATTACHED Page No: 19-39		Within 45 days from the date of award of work.

The successful bidder will be expected to complete the works by the intended completion date specified above.

2. **Qualification of the bidder:** The bidder shall provide qualification information which shall include:-

- (a) Total monetary value of construction works performed for each year of the last 3 years
- (b) Report on his financial standing; and
- (c) Details of any litigation, current or during the last 3 years in which the bidder is involved, the parties concerned and disputed amount in each case.

3. **To qualify for award of the contract the bidder:-**

- (a) should have satisfactorily completed as a prime contractor at least one similar work of value not less than Rs. 500,000 in the last three years;
- (b) should possess valid electrical license for executing building electrification works (in the event of the works being sub - contracted, the sub-contractor should have the necessary license);

- (c) should possess required valid license for executing the water supply/sanitary works (in the event of the works being sub-contracted, the sub-contractor should have the necessary license);

4. Bid Price

- a) The contract shall be for the whole works as described in the Bill of quantities, drawings and technical specifications. Corrections, if any, shall be made by crossing out, initialing, dating and re writing.
- b) All duties, taxes and other levies payable by the contractor under the contract shall be included in the total price.
- c) The rates quoted by the bidder shall be fixed for the duration of the contract and shall not be subject to adjustment on any account.
- d) The rates should be quoted in Indian Rupees only.

5. Submission of Quotations

5.1 The bidder is advised to visit the site of works at his own expense and obtain all information that may be necessary for preparing the quotation.

5.2 Each bidder shall submit only one quotation.

5.3 The quotation submitted by the bidder shall comprise the following :-

- (a) Quotation in the format given in Section **B**.
- (b) Signed Bill of Quantities; and
- (c) Qualification information form given in Section B duly completed.

5.4 The bidder shall seal the quotation in an envelope addressed to the DIRECTOR, DMAPR, BORIAVI-387 310 ANAND (GUJARAT) The envelope will also bear the following identification :-

- Quotation for CONSTRUCTION OF CIVIL/ELECTRICAL/LAN CABLING WORKS FOR CREATION OF A FACILITY FOR A COMPUTER CENTRE FOR PROPOSED ASRB ONLINE EXAM HALL UNDER NAIP AT DMAPR, BORIAVI
- Do not open before **14.30 Hrs on 11.08.10**.

5.5 Quotations must be received in the office of the **AAO, DMAPR, BORIAVI** not later than the time and date given in the letter of invitation. If the specified date is declared a holiday, quotations shall be received up to the appointed time on the next working day.

5.6 Any quotation received by the **DIRECTOR, DMAPR, BORIAVI** after the deadline for submission of quotations will be rejected and returned unopened to the bidder.

6. Validity of Quotation

Quotation shall remain valid for a period not less than 45 days after the deadline date specified for submission.

7. Opening of Quotations

Quotations will be opened in the presence of bidders or their representatives who choose to attend on the date and time and at the place specified in the letter of invitation.

8. Information relating to evaluation of quotations and recommendations for the award of contract shall not be disclosed to bidders or any other persons not officially concerned with the process until the award to the successful bidder is announced.

9. Evaluation of Quotations

The Employer will evaluate and compare the quotations determined to be substantially responsive i.e. which

- (a) meet the qualification criteria specified in clause 3 above;
- (b) are properly signed ; and
- (c) conform to the terms and conditions, specifications and drawings without material deviations.

10. Award of contract

The Employer will award the contract to the bidder whose quotation has been determined to be substantially responsive and who has offered the lowest evaluated quotation price and who meets the specified qualification criteria.

10.1 Notwithstanding the above, the Employer reserves the right to accept or reject any quotations and to cancel the bidding process and reject all quotations at any time prior to the award of contract.

10.2 The bidder whose bid is accepted will be notified of the award of contract by the Employer prior to expiration of the quotation validity period.

11. Performance Security

Within 15 days of receiving letter of acceptance, the successful bidder shall deliver to the DIRECTOR, DMAPR, BORIAVI the performance security (either a bank guarantee or a bank draft in favour of ICAR Unit DMAPR) for an amount equivalent of 3 % of the contract price. The Performance Security shall be valid till the expiry of the period of maintenance of the work, specified in clause 12.

12. Period of Maintenance :

The “Period of Maintenance” for the work is six months from the date of taking over possession or one full monsoon season whichever occurs later. During the period of maintenance, the contractor will be responsible for rectifying any defects in construction free of cost to the Employer.

13. Purchase of all construction materials including cement and steel as per the specifications (ISI certification marked goods wherever available) shall be the responsibility of the contractor.

.....

SECTION - B

- 1. Format for Qualification Information.**
- 2. Format for Submission of Quotation.**
- 3. Format of Letter of Acceptance.**

QUALIFICATION INFORMATION

1 For Individual Bidders

1.1 Principal place of business: _____

Power of attorney of signatory of Quotation.
[Attach copy]

1.2 Total value of Civil Engineering 20____

_____ construction work performed in the last 20____
three years (in Rs. Lakhs) 20____

1.3 Work performed as prime contractor (in the same name) on works of a similar nature over the last three years.

<u>Project Name</u>	<u>Name of Employer</u>	<u>Description of work</u>	<u>Contract No.</u>	<u>Value of contract (Rs.Lakhs)</u>	<u>Date of issue of work order</u>	<u>Stipulated period of completion</u>	<u>Actual date of completion</u>	<u>Remarks explaining reasons for delay and work completed</u>
---------------------	-------------------------	----------------------------	---------------------	-------------------------------------	------------------------------------	--	----------------------------------	--

Existing commitments and on-going works:

<u>Description of Work</u>	<u>Place & State</u>	<u>Contract No. & Date</u>	<u>Value of Contract (Rs. Lakh)</u>	<u>Stipulated period of completion</u>	<u>Value of works* remaining to be completed (Rs. Lakhs)</u>	<u>Anticipated date of completion</u>
(1)	(2)	(3)	(4)	(5)	(6)	(7)

* Enclose a certificate from Engineer concerned.

1.4 Proposed subcontracts and firms involved.

Sections of the works	Value of Sub-contract	Sub-contractor (name & address)	Experience in similar work
*	*	*	*
*	*	*	*
*	*	*	*
*	*	*	*

1.5 Evidence of access to financial resources to meet the requirements of working capital : cash in hand, lines of credit, etc. List them below and attach copies of support documents.

1.6 Name, address, and telephone, telex, and fax numbers of the Bidders' bankers who may provide references if contacted by the Employer.

1.7 Information on litigation history in which the Bidder is involved.

Other party(ies)	Employer	Cause of dispute	Amount involved	Remarks showing present status

QUOTATION

INVITATION FOR QUOTATIONS FOR CONSTRUCTION OF CIVIL WORKS UNDER SHOPPING PROCEDURES

To:

Subject : Construction of

Reference : Letter No.....dated.....from.....

Sir,

We offer to execute the Works described in your letter referred to above in accordance with the Conditions of Contract enclosed therewith at percentage above / below the estimated rates, i.e., for a total Contract Price of -

Rs.** _____ [in figures]
Rs. _____ [in words].

This quotation and your written acceptance of it shall constitute a binding contract between us. We understand that you are not bound to accept the lowest or any quotation you receive.

We hereby certify that we have taken steps to ensure that no person acting for us or on our behalf will engage in bribery.

We hereby confirm that this quotation is valid for 45 days as required in Clause 6 of the Instructions to Bidders.

Yours faithfully,

Authorized Signature : Date: _____

Name & Title of Signatory : _____

Name of Bidder : _____

Address : _____

* To be filled in by the Employer before issue of the Letter of Invitation.

** To be filled in by the Bidder, together with his particulars and date of submission at the bottom of this Form.

**LETTER OF ACCEPTANCE
CUM NOTICE TO PROCEED WITH THE WORK**

(LETTERHEAD OF THE EMPLOYER)

Dated : _____

To : _____ [Name and address of the Contractor]

Dear Sirs,

This is to notify you that your Quotation dated _____ for execution of the _____ for the contract price of Rupees _____ [amount in words and figures], is hereby accepted by us.

You are hereby requested to furnish performance security for an amount of Rs. _____ (equivalent to 3% of the contract price) within 15 days of the receipt of the letter. The Performance Security in the form of Bank guarantee or a Bank draft in favour of(Employer) shall be valid till the expiry of the period of maintenance i.e. upto _____. Failure to furnish the Performance Security will entail cancellation of the award of contract.

You are also requested to sign the agreement form and proceed with the work not later than _____ under the instructions of the Engineer, _____ and ensure its completion within the contract period.

With the issuance of this acceptance letter and your furnishing the Performance Security, contract for the above said work stands concluded.

Yours faithfully,

**Authorized Signature
Name and title of Signatory**

Draft Agreement form for Construction through National Shopping

ARTICLES OF AGREEMENT

This deed of agreement is made in the form of agreement on _____ day _____ month _____ 2010, between the DIRECTOR, DMAPR, BORIAVI or his authorized representative (hereinafter referred to as the first party) and _____ (Name of the Contractor), S/O _____ resident of _____ (hereinafter referred to as the second party), to execute the work of construction of _____ (hereinafter referred to as works) on the following terms and conditions.

2. Cost of the Contract

The total cost of the works (hereinafter referred to as the “total cost”) is Rs. _____ as reflected in Annexure - 1.

3.1 Payments under its contract:

Payments to the second party for the construction work will be released by the first party in the following manner:-

On signing of agreement	:	25% of total cost
On Completion of whole work	:	Full & Final

3.2 Payments at each stage will be made by the first party:

- (a) on the second party submitting an invoice for an equivalent amount ;
- (b) on certification of the invoice (except for the first installment) by the engineer nominated by the first party with respect to quality of works in the format in Annexure - 2; and
- (c) upon proper and justified utilization of at least 50 % of the previous installment and 100 % of any prior installment.

4. Notice by Contractor to Engineer

The second party, on the works reaching each stage of construction, issue a notice to the first party or the Engineer nominated by the first party (who is responsible for supervising the contractor, administering the contract, certifying the payments due to

the contractor, issuing and valuing variations to the contract, awarding extensions of time etc.), to visit the site for certification of stage completion. Within 15 days of the receipt of such notice, the first party or the engineer nominated by it, will ensure issue of stage completion certificate after due verification.

5. Completion time

The works should be completed in 45 days (months/weeks/days) from the date of this Agreement. In exceptional circumstances, the time period stated in this clause may be extended in writing by mutual consent of both the parties.

6. If any of the compensation events mentioned below would prevent the work being completed by the intended completion date, the first party will decide on the intended completion date being extended by a suitable period:

- a) The first party does not give access to the site or a part thereof by the agreed period.
- b) The first party orders a delay or does not issue completed drawings, specifications or instructions for execution of the work on time.
- c) Ground conditions are substantially more adverse than could reasonably have been assumed before issue of letter of acceptance and from information provided to second party or from visual inspection of the site.
- d) Payments due to the second party are delayed without reason.
- e) Certification for stage completion of the work is delayed unreasonably.

7. Any willful delay on the part of the second party in completing the construction within the stipulated period will render him liable to pay liquidated damages. @ Rs. * _____ per day which will be deducted from payments due to him. The first party may cancel the contract and take recourse to such other action as deemed appropriate once the total amount of liquidated damages exceeds 2 % of the contract amount.

(Note : The amount of liquidated damages per day should be determined at 0.05 % of the contract value of the works and indicated here).

8. Duties and responsibilities of the first party

8.1 The first party shall be responsible for providing regular and frequent supervision and guidance to the second party for carrying out the works as per specifications. This will include written guidelines and regular site visit of the authorized personnel of the first

party, for checking quality of material and construction to ensure that it is as per the norms.

- 8.2** The first party shall supply 3 sets of drawings, specifications and guidelines to the second party for the proposed works.
- 8.3** Possession of the site will be handed over to the second party within 10 days of signing of the agreement.
- 8.4** The Engineer or such other person as may be authorized by the first party shall hold meeting once in a month where the second party or his representative at site will submit the latest information including progress report and difficulties if any, in the execution of the work. The whole team may jointly inspect the site on a particular day to take stock of activities.
- 8.5** The Engineer shall record his observations/instructions at the time of his site visit in a site register maintained by the second party. The second party will carry out the instructions and promptly rectify any deviations pointed out by the engineer. If the deviations are not rectified, within the time specified in the Engineer's notice, the first party as well as the engineer nominated by it, may instruct stoppage or suspension of the construction. It shall thereupon be open to the first party or the engineer to have the deviations rectified at the cost of the second party.

9. Duties and responsibilities of the second party

- 9.1** The second party shall :
- a) take up the works and arrange for its completion within the time period stipulated in clause 5;
 - b) employ suitable skilled persons to carry out the works ;
 - c) regularly supervise and monitor the progress of work ;
 - d) abide by the technical suggestions / direction of supervisory personnel including engineers etc. regarding building construction ;
 - e) be responsible for bringing any discrepancy to the notice of the representative of the first party and seek necessary clarification ;
 - f) ensure that the work is carried out in accordance with specifications, drawings and within the total of the contract amount without any cost escalation ;
 - g) keep the first party informed about the progress of work ;
 - h) be responsible for all security and watch and ward arrangements at site till handing over of the building to the first party ; and

- i) maintain necessary insurance against loss of materials/cash, etc. or workman disability compensation claims of the personnel deployed on the works as well as third party claims.
- f) Pay all duties, taxes and other levies payable by construction agencies as per law under the contract (First party will effect deduction from running bills in respect of such taxes as may be imposed under the law).

10. Variations / Extra Items

The works shall be carried out by the second party in accordance with the approved drawings and specifications. However, if, on account of site conditions or any other factors, variations are considered necessary, the following procedure shall be followed:-

- a) The second party shall provide the Engineer with a quotation for carrying out the Variation when requested to do so by the Engineer. The Engineer shall assess the quotation, which shall be given within seven days of the request before the Variation is ordered.
- b) If the quotation given by the second party is unreasonable, the Engineer may order the Variation and make a change to the Contract Price which shall be based on Engineer's own forecast of the effects of the Variation on the Contractor's costs.
- c) The second party shall not be entitled to additional payment for costs which could have been avoided by giving early warning.

11. Securities

The Performance Security shall be provided to the Employer no later than the date specified in the Letter of Acceptance and shall be issued in an amount and form and by a bank or surety acceptable to the Employer. The Performance Security shall be valid until a date 28 days from the date of issue of the Certificate of Completion in the case of a Bank Guarantee.

12. Termination

- 12.1 The Employer may terminate the Contract if the other party causes a fundamental breach of the Contract.
- 12.2 Fundamental breaches of Contract include, but shall not be limited to the following:
 - (a) the contractor stops work for 28 days and the stoppage has not been authorized by the Engineer;

- (b) the Contractor has become bankrupt or goes into liquidation other than for a reconstruction or amalgamation;
 - (c) the Engineer gives Notice that failure to correct a particular Defect is a fundamental breach of Contract and the Contractor fails to correct it within a reasonable period of time determined by the Engineer;
 - (d) the Contractor does not maintain a security which is required;
- 12.3 Notwithstanding the above, the Employer may terminate the Contract for convenience.
- 12.4 If the Contract is terminated the Contractor shall stop work immediately, make the Site safe and secure and leave the Site as soon as reasonably possible.

13. Payment upon Termination

- 13.1 If the Contract is terminated because of a fundamental breach of Contract by the Contractor, the Engineer shall issue a certificate for the value of the work done less advance payments received up to the date of the issue of the certificate, less other recoveries due in terms of the contract, less taxes due to be deducted at source as per applicable law.
- 13.2 If the Contract is terminated at the Employer's convenience, the Engineer shall issue a certificate for the value of the work done, the reasonable cost of removal of Equipment, repatriation of the Contractor's personnel employed solely on the Works, and the Contractor's costs of protecting and securing the Works and less advance payments received up to the date of the certificate, less other recoveries due in terms of the contract and less taxes due to be deducted at source as per applicable law.

14. Dispute settlement

If over the works, any dispute arises between the two parties, relating to any aspects of this Agreement, the parties shall first attempt to settle the dispute through mutual and amicable consultation.

In the event of agreement not being reached, the matter will be referred for arbitration by a Sole Arbitrator not below the level of retired Superintending Engineer, PWD to be appointed by the first party. The Arbitration will be conducted in accordance with the Arbitration and Conciliation Act, 1996. The decision of the Arbitrator shall be final and binding on both the parties.

BILL OF QUANTITIES

Sl. No.	Description of Work	Qty.	Unit	Estimated Cost		Amount
				In figure (Rs.)	In Words	

Gross Total Cost : Rs.

We agree to execute the works in accordance with the approved drawings and technical specifications at percentage above/below the estimated rates, i.e., for a total contract price of Rs.(amount in figures) (Rs. amount in words).

Signature of Contractor

Format of certificate

Certified that the works upto ----- level in respect of construction of ----- at ----- have been executed in accordance with the approved drawing and technical specifications.

Signature
Name & Designation
(Official address)

Place :
Date :

Office seal

Existing Layout Plan

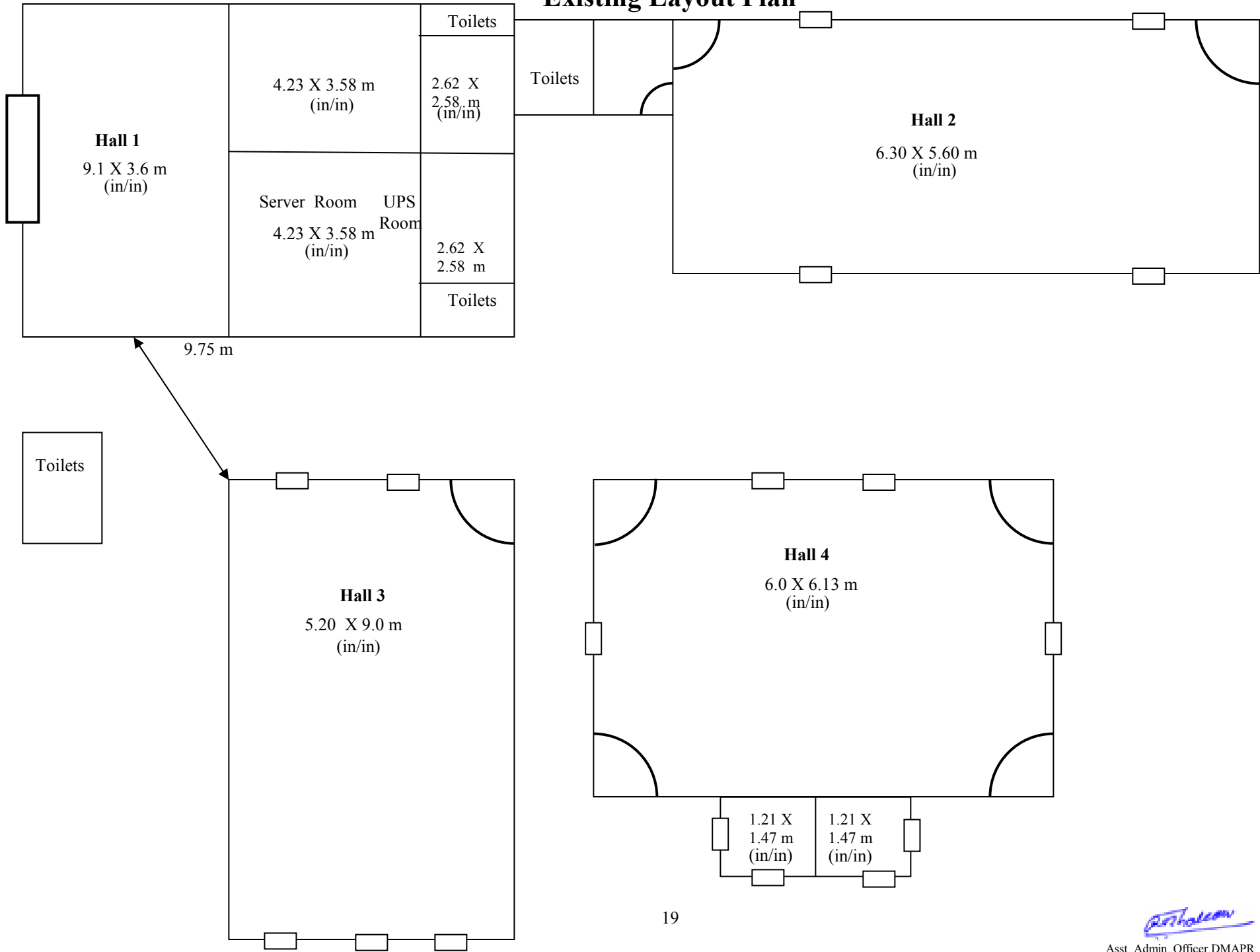

Arshad Khan

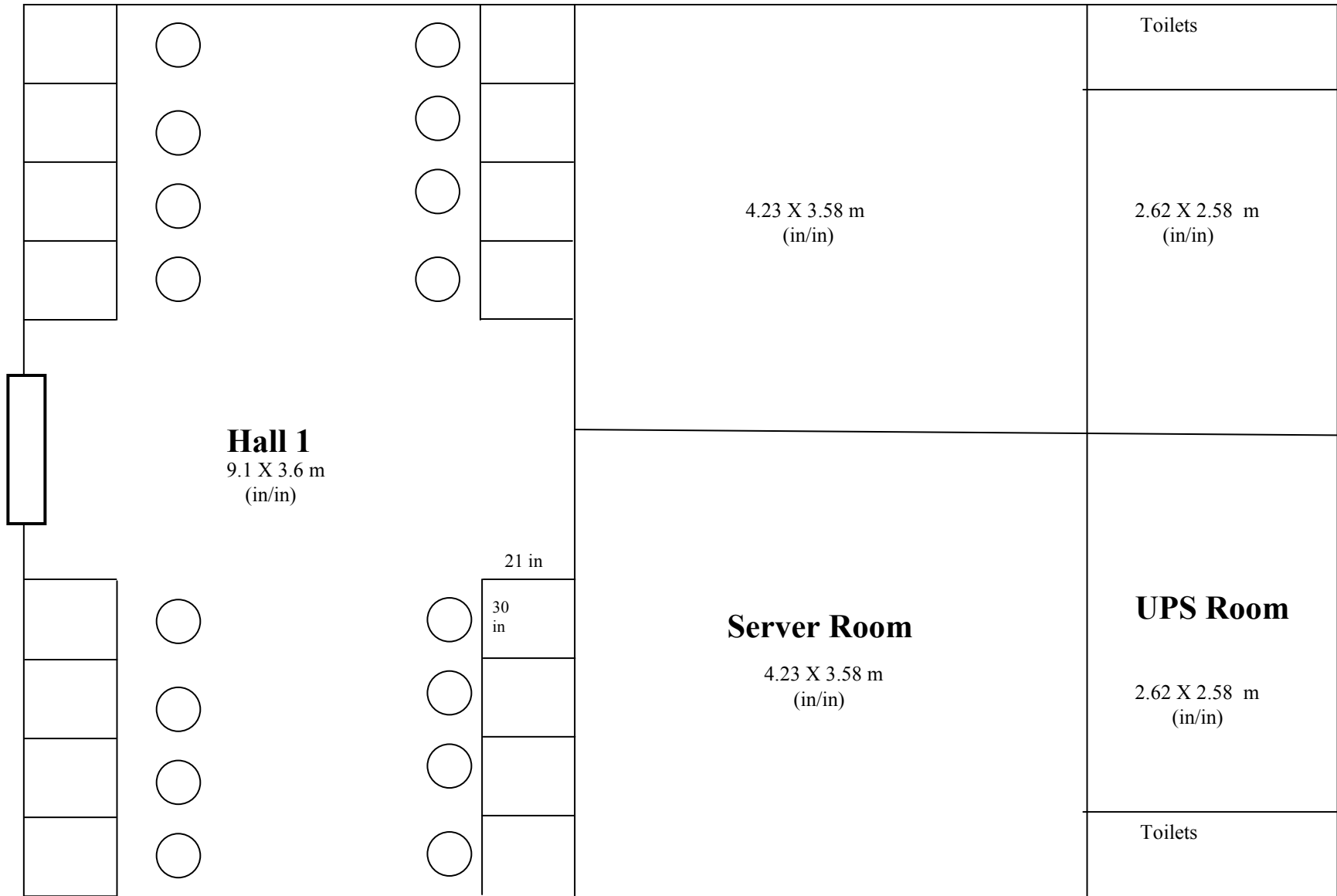

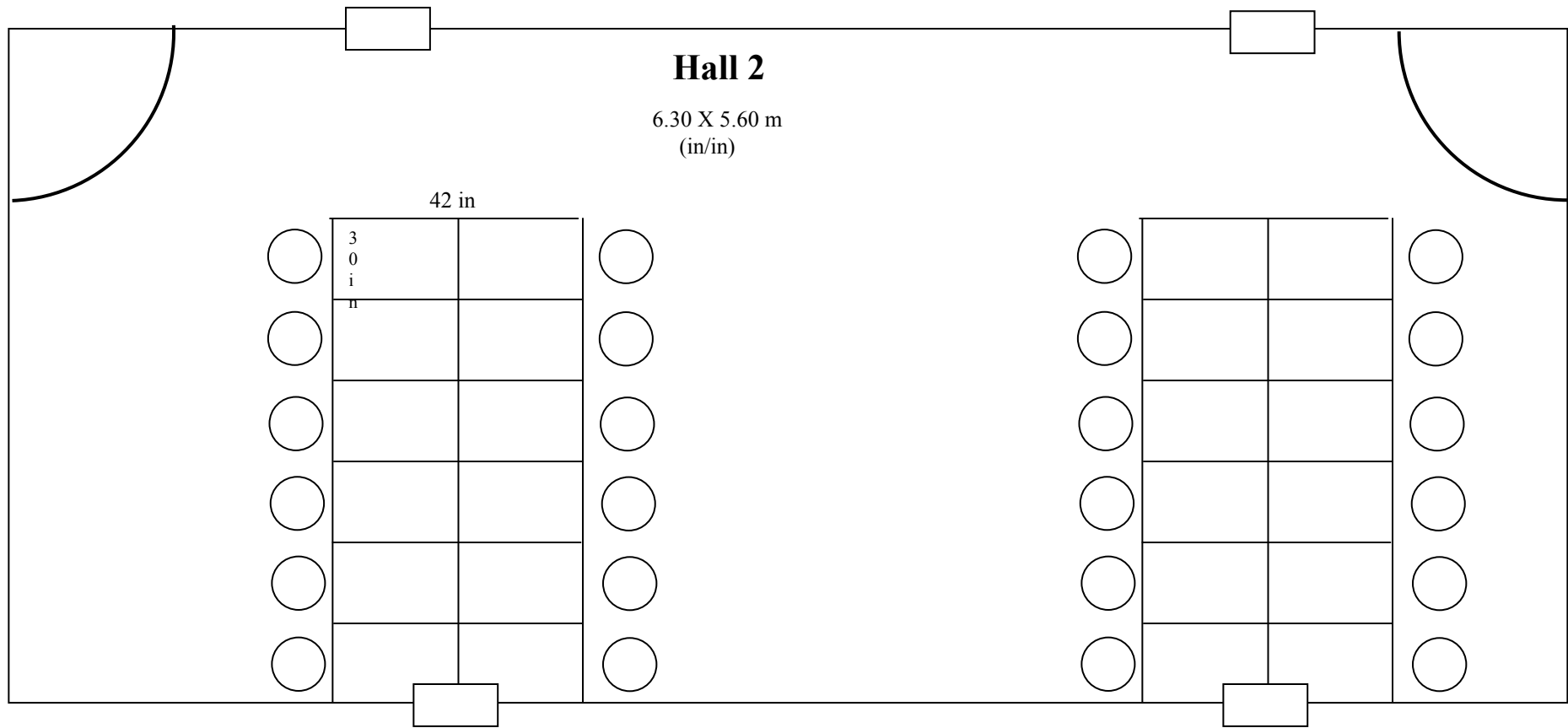

Hall 3

5.20 X 9.0 m

(in/in)

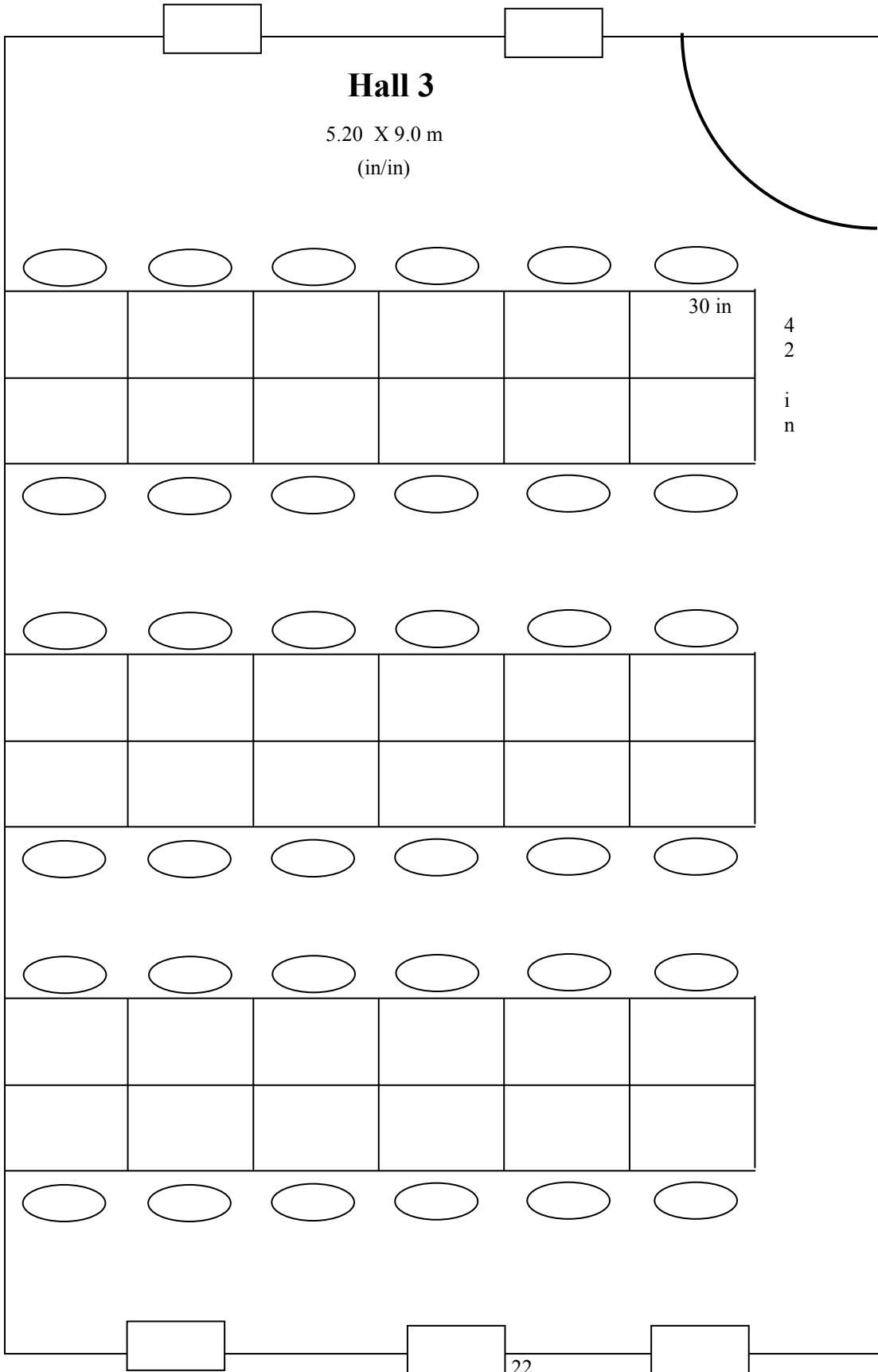

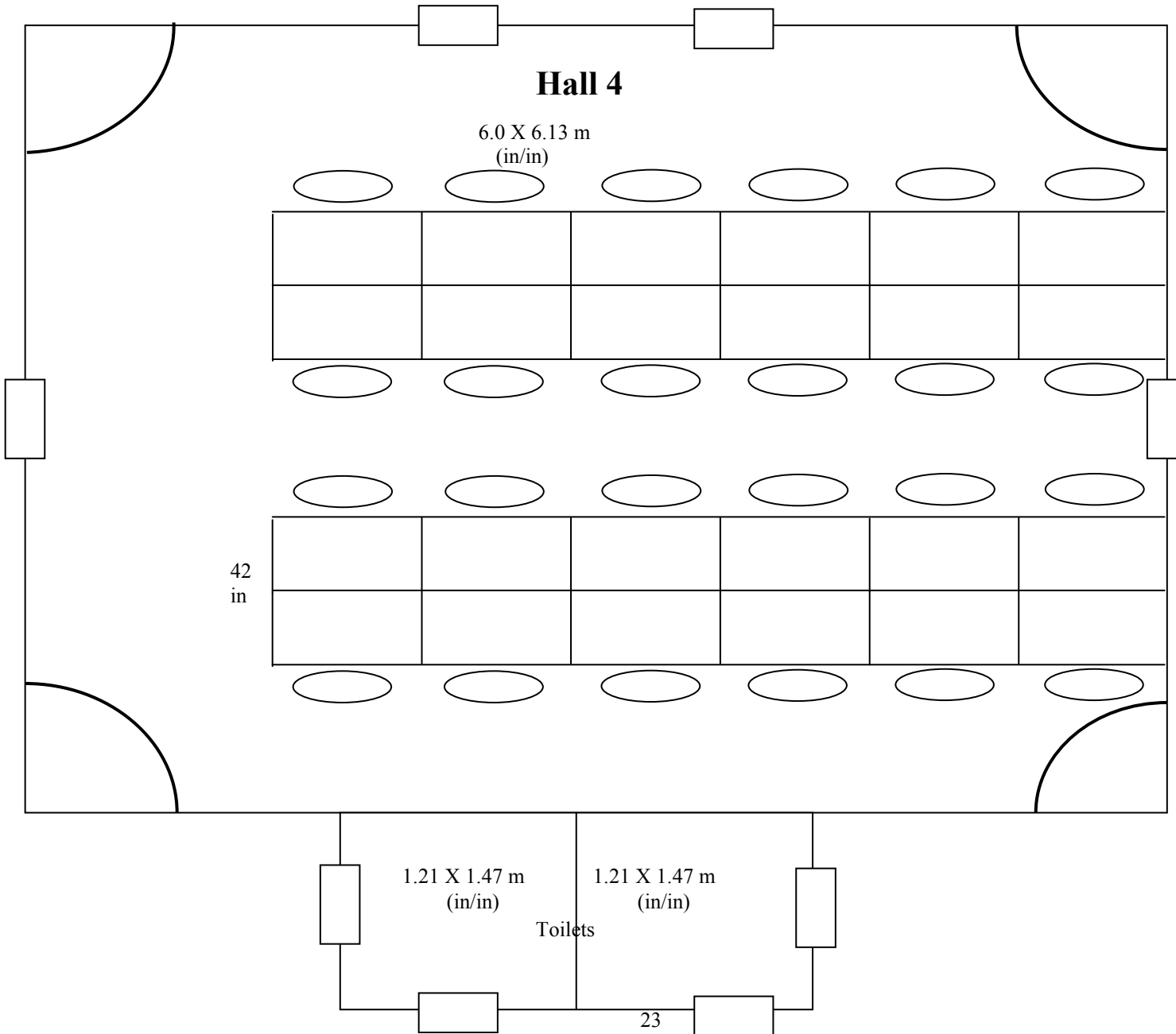

Arthakom

**CIVIL/ELECTRICAL/LAN WORK FOR CREATION OF COMPUTER CENTER FOR ONLINE ASRB EXAM AT DMAPR,
BORIAVI**

S. No	Description of work	Qty	Unit	Estimated Cost		Amount (Rs)
				In figure (Rs)	In words	
1	Earth work in excavation by mechanical means (Hydraulic excavator)/ manual means in foundation treanches or drains (not exceeding 1.5m in width or 10 sum on plan) including dressing of sides and ramming of bottoms, lift upto 1.5m including getting out the excavated soil and disposal of surplus excavated soil as directed, within in a lead of 50m. All kinds of soil.	25	cum			
2	Filling available excavated earth (excluding rock) in trenches, plinth, sides of foundations etc. in layers not exceeding 20cm in depth, consolidating each deposited layer by ramming and watering, lead up to 50 m and lift upto 1.5 m.	25	cum			
3	Supplying and filling in plinth with local river sand under floors including, watering, ramming consolidating and dressing complete.(M.R.)	14	cum			
4	Providing and laying in position cement concrete of specified grade excluding the cost of centring and shuttering - All work upto plinth level 1:2:4 (1 cement : 2 coarse sand : 4 graded stone aggregate 20 mm nominal size)	7	cum			
5	Providing and laying in position cement concrete of specified grade excluding the cost of centring and shuttering - All work upto plinth level 1:5:10 (1 cement : 5 coarse sand : 10 graded stone aggregate 40 mm nominal size).	15	cum			
6	Providing and laying cement concrete in retaining walls, return walls, walls (any thickness) including attached pilasters, columns, piers, abutments, pillars, posts, struts, buttresses, string or lacing courses, parapets, coping, bed blocks, anchor blocks, plain window sills, fillets etc. upto floor five level, excluding the cost of centring, shuttering and finishing : 1:2:4 (1 Cement : 2 coarse sand : 4 graded stone aggregate 20 mm nominal size)	1.6	cum			

7	Centring and shuttering including strutting, propping etc. and removal of form work for : Lintels, Beams, Plinth Beams, gudders, bressumers and cantilevers.	17	sqm			
8	Making plinth protection 50mm thick of cement concrete 1:3:6 (1 cement : 3 coarse sand : 6 graded stone aggregate 20 mm nominal size) over 75mm bed by dry brick ballast 40mm nominal size well rammed and consolidated and grouted with fine sand including finishing the top smooth.	67	sqm			
9	Brick work with F.P.S. bricks of class designation as specified in foundation and plinth in: Cement mortar 1:6 (1 cement: 6 coarse sand).	6	cum			
10	Brick work with F.P.S. bricks of class designation 75 in in superstructure above plinth level upto floor V level in all shapes and sizes in : Cement mortar 1:6 (1 cement : 6 coarse sand)(M.R)	7	cum			
11	Providing and fixing 18mm thick gang saw cut mirror polished (premoulded and prepolished) machine cut marble for window sills, facias and similar locations of required size of approved shade, colour and texture laid over 20mm thick base cement mortar 1:4 (1 cement : 4 coarse sand) with joints treated with white cement, mixed with matching pigment, epoxy touch ups, including rubbing, curing, moulding and polishing to edge to give high gloss finish etc. complete at all levels. Udaipur green marble, Area of slab over 0.50 sum	22	sqm			
12	Providing and fixing IS : 3564 marked Aluminium extruded section body tubular type universal hydraulic door closer with double speed adjustment with necessary accessories and screws etc. complete.	6	nos			
13	Steel work in built up tubular trusses including cutting, hoisting fixing in position and applying a priming coat of approved steel primer, welded and bolted including special shaped washers etc. complete. Hot finished welded type tubes.	850	kg			

14	Steel work welded in built up sections/framed work including cutting, hoisting, fixing in position and applying a priming coat of approved steel primer using structural steel etc. as required. In gratings, frames, guard bar, ladder, railings, brackets, gates and similar works.	320	kg			
15	Providing and fixing in position collapsible steel shutters with vertical channals 20 X 10 X 2 mm and braced with flat iron diagonals 20 X 5 mm size with top and bottom rail of T-Iron 40X40X6 mm with 40 mm dia steel, pulleys complete with bolts, nuts locking arrangement, stoppers, handles including applying a priming coat of approved steel primer.	13	sqm			
16	Providing and fixing 1st quality ceramic glazed wall tiles of size 300x450 mm of 9 mm thick jointless tiles of approved make in all colours, shades as approved by Engineer-in-Charge in skirting, risers of steps and dados over 12 mm thick bed of cement Mortar 1:3 (1 cement : 3 coarse sand) and jointing with grey cement slurry @ 3.3kg per sum including pointing in white cement mixed with pigment of matching shade complete.	12	sqm			
17	Providing and laying ceramic glazed floor tiles 300x300 mm (thickness to be specified by manufacturer) of 1st quality confirming to IS: 15622 of approved make in colours such as White, Ivory, Grey, fume Red Brown, laid on 20mm thick cement mortar 1:4 (1 cement : 4 coarse sand) including pointing the joints with white cement and matching pigments etc. complete.	10	sqm			
18	Kota stone slab flooring over 20mm (average) thick base laid over and jointed with grey cement slurry mixed with pigment to match the shade of the slab including rubbing and polishing complete with base of cement mortar 1 : 4 (1 cement : coarse sand) : 25mm thick.	90	sqm			
19	Extra for providing and fixing wind ties of 40x 6mm flat iron section.	42	metre			
20	Providing and fixing on wall face Unplasticised Rigid PVC rain water pipes conforming to IS : 13592 Type A including jointing with seal ring conforming to IS : 5382 leaving 10 mm gap for thermal expansion. (i) Single socketed pipes: 110 mm diameter.	30	metre			

21	Providing and fixing on wall face Unplasticised - PVC moulded fittings/accessories for Unplasticised Rigid PVC rain water pipes conforming to IS : 13592 Type A including jointing with seal ring conforming to IS : 5382 leaving 10 mm gap for thermal expansion: 110 mm bend.	6	each			
22	Providing and fixing on wall face Unplasticised - PVC moulded fittings/accessories for Unplasticised Rigid PVC rain water pipes conforming to IS : 13592 Type A including jointing with seal ring conforming to IS : 5382 leaving 10 mm gap for thermal expansion: 110 mm shoe.	6	each			
23	Providing and fixing Unplasticised -PVC pipe clips of approved design to Unplasticised - PVC rain water pipes by means of 50x50x50mm hard wood plugs, screwed with M.S. screws of required length including cutting brick work and fixing in cement mortar 1:4 (1 cement : 4 coarse sand) and making good the wall etc. complete. 110 mm	10	each			
24	Providing and fixing at all height false ceiling including providing and fixing of frame work made of special sections power pressed from M.S. sheet and galvanised in accordance with zinc coating of grade 350 as per IS : 277 and consisting of angle cleats of size 25mm wide x 1.6mm thick with flanges of 22mm and 37mm at 1200mm centre to centre one flange fixed to the ceiling with dash fastener 12.5mm diax40mm long with 6mm dia bolts to the angle hangers of 25x25x0.55mm of required length, and other end of angle hanger being fixed with nut and bolts to G.I. channels 45x15x0.9mm running at the rate of 1200mm centre to centre to which the ceiling section 0.5mm thick button wedge of 80mm with tapered flanges of 26mm each having clips of 10.5mm at 450mm centre to centre shall be fixed in a direction perpendicular to G.I. channel with connecting clips made out of 2.64mm diax230mm long G.I. wire at every junction including fixing the gypsum board with ceiling section and perimeter channels 0.5mm thick 27mm high having flanges of 20mm and 30mm long, the perimeter of ceiling fixed to wall/partition					

	with the help of rawl plugs at 450mm centre to centre with 25mm long drive-all screws @ 230mm interval including jointing and fixing to a flush finish of tapered and square edges of the board with recommended filler, jointing tapes, finisher and two coats of primer suitable for board as per manufactures specification and also including the cost of making openings for light fittings, grills, diffusers, cutouts made with frame of perimeter channels suitably fixed all complete as per drawing and specification and direction of the Engineer in Charge but excluding the cost of painting with :12.5 mm thick tapered edge gypsum board conforming to IS: 2095 - Part I.	90	sqm			
25	Supply & installation of precoated galvanized iron profile sheets (size, shape and pitch of corrugation as approved by Engineer-in-charge) 0.50 mm +/- 5% total coated thickness (TCT), thick Zinc coating 120gsm as per IS: 277 in 240mpa steel grade, 5-7 microns epoxy primer on both side of the sheet and polyester top coat 15-18 microns. Sheet should have protective guard film of 25 microns minimum to avoid scratches while transportation and should be supplied in single length upto 12 metre or as desired by Engineer-in-charge. The sheet shall be fixed using self drilling/self tapping screws of size (5.5x 55mm) with EPDM seal or with polymer coated J or L hooks, bolts and nuts 8mm diameter with bitumen and G.I. limpet washers or with G.I. limpet washers filled with white lead complete upto any pitch in horizontal/vertical or curved surfaces excluding the cost of purlins, rafters and trusses and including cutting to size and shape wherever required.	64	sqm			
26	Providing and fixing precoated galvanised steel sheet roofing accessories 0.50 mm +/- 5% total coated thickness (TCT), Zinc coating 120gsm as per IS: 277 in 240mpa steel grade, 5-7 microns epoxy primer on both side of the sheet and polyester top coat 15-18 microns using self drilling/self tapping screws or with polymer coated J or L hooks, bolts and nuts and or G.I. seam bolts and nuts, G.I. plain and bitumen washers complete : Ridges plain (500 - 600mm).	16	metre			

27	Making POP moulding of size up to 100mm of approved pattern and design in false ceiling work including finishing smooth without any warping,fixing with screws,priming coat with cement primer etc.all completeas per direction of engineer-in-charge. (M.R.)	77	metre			
28	12 mm cement plaster finished with a floating coat of neat cement of mix : 1:4 (1 cement : 4 fine sand).	100	sqm			
29	18 mm cement in two coats under layer 12 mm thick cement plaster 1:5 (1 cement : coarse sand) and top layer 6mm thick cement plaster 1:3 (1 cement : 3 coarse sand) finished rough with sponge.	150	Sqm			
30	Prividing and fixing factory made PVC door frame of size 50x47mm with a wall thickness of 5mm made out of extruded 5mm rigid PVC foam sheet mitred at corners and joined with two no. of 150mm long brackets of 15x15mm M.S. square tybe, the verticle door profiles to be reinforced with 19x19mm M.S. square tube of 19 gauge, EPDM rubber gasket weather seal to be provided through out the frame. The door frame to be fixed to the wall using M.S. screws of 65/100 mm size complete as per manufacture specification and direction of Engineer-In-Charge.	10	metre			
31	30mm thick factory made solid both side pre-laminated panel PVC door, shutter consisting of frame made out of M.S. tube of 19 gauge thickness and size of 19mm x 19mm for styles and 15x15mm for top and bottom rais. M.S. frame shall have a coat of steel primers of approved make and manufacture, M.S. frame covered with 5mm thick heat moulded pre-laminated PVC 'C' channel of size 30mm thickness, 70mm width out of which 50mm shall be flat and 20mm shall be tapered in 45deegre angle on either side forming styles; and 5mm thick 95mm wide PVC sheet out of which 75mm shall be flat and 20mm shall be tapered in 45deegre on the inner side to from top and bottom rail and 115mm wide PVC sheet out of which 75mm shall be flat and 20mm shall be tapered on both side to form lock rail. Top, bottom and lock rails shall be provided either side of the panel. 10mm (5mmx2) thick, 20mm wide cross PVC sheet be provided as gap insert for top rail and bottom rail. panelling of 5mm thick both side pre-laminated PVC sheet to be fitted in the M.S. sheet welded/sealed to the styles	3.5	Sqm			

	and rails with 7mm (5mm+2mm) thick x 15mm wide PVC sheet beading on inner side, and joined together with solvent cement adhesive. In additional 5mm thick PVC strip of 20mm width is to be stuck on the interior side of the 'C' channel using PVC solvent adhesive etc. complete as per direction of Engineer-In-Charge: Manufacture's specification and drawing (for W.C. and bathroom door shutter).					
32	Providing and fixing verticle blind (strip type) window curtain with all accessories etc. complete. (M.R.).	38	Sqm			
33	Repairs to plaster to thickness 12mm to 20mm in patches of area 2.5 sqm. and under including cutting the page in proper shape, raking out, joints and prepairing and plastering the surface of the wall complete including disposal rubbish to the dumping ground within 50m. lead, With cement mortar : 1 : 4 (1 cement : 4 coarse sand).	30	Sqm			
34	Providing and applying plaster of paris putty of 2 mm thickness over plastered surface to prepare the surface even and smooth complete.	500	sqm			
35	Applying one coat of cement primer of approved brand and manufacture on wall surface : Cement primer.	500	sqm			
36	Wall painting with distamper paint of approved brand and manufacture to give an even shade: Two or more coats on new work.	500	sqm			
37	Finishing wall with Acrylic Smooth exterior paint " Apex Ultima of Asian paints Wheathershield max of ICI Dulux or equivalentat all height and at all level etc complete New work (Two or more coats apply @ 1.43 lit/10 sqm including base coat of exterior wall primer X2 of Asian Paints or equivalent applied @ .80 lit/10sqm.) (M.R.).	505	sqm			
38	Painting with synthetic enamel paint of approved brand and manufacture of required colours to give an even shade: Two or more coats on new work over and under coat of suitable shade with ordinary paint of approved brand and manufacture.	64	sqm			
39	Removing white or colour wash by scrapping and sand papering and preparing the surface smooth including necessary repairs to scratches etc. complete.	380	sqm			

40	Demolishing cement concrete manually/ by mechanical means including disposal of material within 50 metres lead as per direction of Engineer-in-charge. 1:3:6 or richer mix.	13	cum			
41	Demolishing brick work manually/ by mechanical means including stacking of serviceable material and disposal of unserviceable material within 50 metres lead as per direction of Engineer-in-charge. In cement mortar.	20	cum			
42	Dismantling steel work in single sections including dismembering and stacking within 50 metres lead in: Channels, angles, tees and flats.	100	kg			
43	Dismantling roofing including ridges, hips valleys and gutters etc., and stacking the material within 50 metres lead of Asbestos sheet.	64	sqm			
44	Taking out doors, windows and clerestory window shutters (steel or wood) including stacking within 50 metres lead: Of area beyond 3 sq. metres.	18	each			
45	Dismantling old plaster or skirting raking out joints and cleaning the surface for plaster including disposal of rubbish to the dumping ground within 50 metres lead.	70	sqm			
46	Dismantling aluminium/ Gypsum partitions, doors, windows, fixed glazing and false ceiling including disposal of unserviceable surplus material and stacking of serviceable material with in 50 meters lead as directed by Engineer-in-charge.	37	sqm			
47	Providing and fixing 80mm thick reflective coloured precast concrete interlocking paver blocks as per required size ,shade and geometric shape with minimum charecteristic strength of 350 kg /cm ² in pavement of approved manufacturer on a 30mm thick bed of sand including cleaning of joints and compacting with surface vibrator etc. complete. (M.R.)	60	sqm			
48	Providing and fixing white vitreous china pedestal type water closet (European type w.c. pan) with seat and lid, 10 litre low level P.V.C. flushing cistern with manually controlled device (handle lever), conforming to IS : 7231, with all fittings and fixtures complete including cutting and making good the walls and floors wherever required : W.C. pan with ISI marked white solid plastic seat and lid.	1	each			

49	Providing and fixing wash basin with C.I. brackets, 15 mm C.P. brass pillar taps, 32 mm C.P. brass waste of standard pattern, including painting of fittings and brackets, cutting and making good the walls wherever require : White Vitreous China Flat back wash basin size 550x400 mm with single 15 mm C.P. brass pillar tap.	1	each			
50	Providing and fixing P.V.C. waste pipe for sink or wash basin including P.V.C. waste fittings complete. Flexible pipe 40 mm dia.	3	each			
51	Providing and fixing soil, waste and vent pipes : Centrifugally cast (spun) iron socketed pipe as per IS: 3989: 100mm dia.	6	Meter			
52	Providing and fixing bend of required degree with access door, insertion rubber washer 3 mm thick, bolts and nuts complete: Sand cast iron S&S as per IS:3989 - 100 mm dia.	2	each			
53	Providing lead caulked joints to sand cast iron/ centrifugally cast (spun) iron pipes and fittings of diameter: 100 mm.	10	each			
54	Providing and fixing trap of self cleansing design with screwed down or hinged grating with or without vent arm complete, including cost of cutting and making good the walls and floors : Sand cast iron S&S as per IS: 3989- 100mm inlet & 75 mm outlet.	1	each			
55	Painting sand cast iron/ centrifugally cast (spun) iron soil, waste vent pipes and fittings with paint of any colour such as chocolate grey, or buff etc. over a coat of primer (of approved quality) for new work : 100 mm diameter pipe.	6	each			
56	Providing and fixing C.P. brass Jet spray of standard quality and approved brand for Indian E.W.C.pan including other fittings, union etc. complete (M.R.).	1	each			

57	Providing and fixing G.I. pipes complete with G.I. fittings and clamps, including cutting and making good the walls etc.: Internal work - Exposed on wall 25 mm dia. nominal bore	16	metre			
58	Concealed pipe including painting with anti corrosive bitumastic paint, cutting chases and making good the wall. 15 mm dia nominal bore.	14	metre			
59	Making connection of G.I. distribution branch with G.I. main of following sizes by providing and fixing tee, including cutting and threading the pipe etc. complete : 25 to 40 mm nominal bore.	1	each			
60	Providing and fixing uplasticised PVC connection pipe with brass unions : 45 cm length 15 mm nominal bore.	2	each			
61	Painting G.I. pipes and fittings with synthetic enamel white paint over a ready mixed priming coat, both of approved quality for new work : 25 mm diameter pipe.	16	Meter			
62	Providing and fixing C.P. brass bib cock of approved quality conforming to IS:8931 15 mm nominal bore.	1	each			
63	Providing and fixing C.P. brass angle valve for basin mixer and geyser points of approved quality conforming to IS:8931 15 mm nominal bore.	3	each			
64	Providing and fixing gun metal gate valve with C.I. wheel of approved quality (screwed end): 25mm nominal bore.	2	Each			
65	Providing, laying and jointing glazed stoneware pipes grade 'A' with stiff mixture of cement mortar in the proportion of 1:1 (1 cement : 1 fine sand) including testing of joints etc. complete : 150 mm diameter.	15	metre			
66	Providing and laying cement concrete 1:5:10 (1 cement : 5 coarse sand : 10 graded stone aggregate 40 mm nominal size) all-round S.W. pipes including bed concrete as per standard design: 150 mm diameter S.W. pipe.	15	metre			

67	Providing and fixing square-mouth S.W. gully trap grade 'A' complete with C.I. grating brick masonry chamber with water tight C.I. cover with frame of 300 x300 mm size (inside) the weight of cover to be not less than 4.50 kg and frame to be not less than 2.70 kg as per standard design : 100x100 mm size P type With F.P.S. Bricks class designation 75.	1	each			
68	Constructing brick masonry man hole in cement mortar 1:4 (1 cement : 4 coarse sand) R.C.C. top slab with 1:2:4 mix (1 cement : 2 coarse sand : 4 graded stone aggregate 20mm nominal size), foundation concrete 1:4:8 mix (1 cement : coarse sand : 8 graded stone aggregate 40mm nominal size) inside plastering 12 mm thick with cement mortar 1:3 (1 cement : 3 coarse sand) finished with floating coat of neat cement and making channels in cement concrete 1:2:4 (1 cement : 2 coarse sand : graded stone aggregate 20mm nominal size) finished with a floating coat of neat cement complete as per standard design: Inside size 90x80cm and 45cm deep including C.I.cover with frame (light duty) 455x610mm internal diamentions total weight of cover and frame to be not less than 38 Kg. (weight of cover 23 Kg. and weight of frame 15 Kg.).	2	Nos			
69	Providing and fixing Colour Anodised Aluminium Section, partly panelled partly glazed aluminum Door using Alu. Section Jindal / Banco Aluminium Ltd. Door frame (101.60 x 44.50 x 3.15 mm thick x 2.14/ Rmt.Wt.) of shutter vertical section (63.05 x38.0 x 1.60 mm wt. 1.25 kg./ Rmt) top section (83.5x 44.5 x 2.70 mm wt. 1.84 Kg. / RMT.) bottom Section (85.0 x 44.45 x 2.00 mm wt. 1.66 Kg./ Rmt) including fixing 5 mm thick transclucoat glass of approved quality and 12 mm thick prelaminated partical board of exterior grade with alu. Cleat and EDPM Jumbow rubber sealing/ Glass wool including necessary fitting and fastening like S.S. Hinges, american type handle, door stopper, locking, arrangement with aluminium/ metal screw and filling with silicon between section sealent and wall/ an sufrface gap between wall and section etc. complete as per instruction of Engineer - in Charge. (M.R.)	6.5	Smt			

70	<p>Providing and fixing Alluminium Colour anodised approved colour fully glazed sliding window using main frame of Jindal / Banco size 65mm x 25mm x 1.25 mm having weight of. 0.590 kg/M. horizontal two track member. Size 61.85 mm x 31.75 mm x 1.20 mm having weight of 0.695 kg/m vertical member of size 61.85 mm x 31.75 mm x 1.30 mm having weight of 0.659 kg/m. shutter frame for vertical member of size 40mm x 18mm x 1.29 mm having weight of 0.456 kg/m, horizontal of size 40mm x 18mm x 1.29 mm having weight 0.456 kg/m and silicon gasket and rubber packing with 4 mm thick transluceat galss and fixing locking arrangement etc. complete.(M.R.)</p>	16	Sq.Mt.			
71	<p>Providing and laying integral cement based water proofing treatment including preparation of surface as required for treatment of roofs, balconies, terraces etc consisting of following operations:</p> <p>a) Applying a slurry coat of neat cement using 2.75 kg/sum. of cement admixed with water proofing compound conforming to IS. 2645 and approved by Engineer-in-charge over the RCC slab including adjoining walls upto 300mm height including cleaning the surface before treatment.</p> <p>b) Laying brick bats with mortar using broken bricks/brick bats 25 mm to 115mm size with 50% of cement mortar 1:5 (1 cement : 5 coarse sand) admixed with water proofing compound conforming to IS : 2645 and approved by Engineer-in-charge over 20 mm thick layer of cement mortar of mix 1:5 (1 cement :5 coarse sand) admixed with water proofing compound conforming to IS : 2645 and approved by Engineer-in-charge to required slope and treating similarly the adjoining walls upto 300 mm height including rounding of junctions of walls and slabs</p>					

	<p>c) After two days of proper curing applying a second coat of cement slurry using 2.75kg/ sum of cement admixed with water proofing compound conforming to IS : 2645 and approved by Engineer-in-charge.</p> <p>d) Finishing the surface with 20 mm thick jointless cement mortar of mix 1:4 (1 cement :4 coarse sand) admixed with water proofing compound conforming to IS : 2645 and approved by Engineer-in-charge including laying glass fibre cloth of approved quality in top layer of plaster and finally finishing the surface with trowel with neat cement slurry and making pattern of 300x300 mm square 3mm deep. e) The whole terrace so finished shall be flooded with water for a minimum period of two weeks for curing and for final test. All above operations to be done in order and as directed and specified by the Engineer-in-Charge : With average thickness of 120mm and minimum thickness at khurra as 65 mm.</p>	85	sqm			
TOTAL 'A' (Rs.)						

ELECTRICAL/LAN CABLING WORK

(Make & model no. may be mentioned wherever applicable)

Sr. No.	Description of Work	Unit	Qty	Estimated Cost		Amount (Rs)
				In figure (Rs)	In words	
1	Supply & Installation of SITC of 3 - Phase, 4 way Verticle Type Distribution Board for Raw power, with 63 Amp 4 pole MCB as incomer and 32A TP MCB-1 No and 20A SP MVB-9 Nos as outgoing, duly prewired, ready to use, Including all necessary hardwares & accessories complete. (In Hall no 3)(For A/C's of hall no 3,4 and outgoing to three phase DB in hall no.2) (M.R.)	Nos.	1			

2	Supply & Installation of SITC of 3 - Phase, 4 way Distribution Board for Raw power, with 63 Amp 4 pole MCB as incomer and 20A SP MCB-12 Nos as outgoing, duly prewired, ready to use, Including all necessary hardwares & accessories complete. (In Hall no 2)(For A/C's of hall no 2) (M.R.)	Nos.	1			
3	Supply, Installation, testing and commissioning of 2 X 36W CFL lighting fittingsinc Including all necessary hardwares & accessories complete. (hall no 1-4,Hall no 2-4 Hall no 3- 4, Hallno no. 4) (M.R.)	Nos	18			
4	Supply & Installation of SITC of 1 phase Industrial socket (for A/C point) having 20 Amp MCB including all necessary hardwares & accessories complete. (M.R)	Nos.	8			
5	Supply & Installation of Computer Point 1 modular switch & 2 modular socket- S/F PVC Surface box with plate and one no 5A switch and two nos 5A 5 Pin socket including supply of switch, socket and PVC Box with plate (M.R.)	Nos.	102			
6a	Supply and laying of 1100V grade, armored, PVC insulated, 4C X 16 sqmm CU armored cable For Raw power from Sub station to vertical DB in Hall No 3) in ground/surface/existing pipe/duct etc Unit including all necessary hardwares & accessories complete. (M.R)	RMT	60			
6b	Supply and laying of 1100V grade, unarmored, PVC insulated, 1.1KV grade, 3C X 4 sqmm CU flexible cable (For 3 Computer plugs and A/c)on surface including all necessary hardwares & accessories complete. (M.R)	RMT	700			
7	S/F Point wiring with modular type switch: Wiring for Light pt/fan pt/exhaust fan pt/call bell pt with 1.5 sq.mm. FR PVC insulated copper conductor single core cable in surface / recessed PVC conduit with modular switch, modular plate, suitable GI box and earthing the point with 1.5 sq.mm. FR PVC insulated copper conductor single core cable etc as required.(Recessed conduit on wall & surface conduit on ceiling).Group C	PTS	10			

8	S/F on surface of U-PVC trunking complete with cover & standard accessories of following size. (Suitable for cable management system - Wall) Size : 100mm x 50mm with two separators (M.R.)	RMT	75			
9	Supplying and fixing following size modular switch and socket on the existing modular plate and switch box including connection but excluding modular plate as required. (M.R.)					
(a)	5/6 amps switch (For converting existing P/T switch into modular switch)	Nos.	20			
(b)	5/6 amps socket (For converting existing P/T socket into modular socket)	Nos.	4			
(c)	5 step fan regulator (For converting existing fan regulator into modular regulator)	Nos.	8			
(d)	15/16 amps switch (For converting existing P/T switch into modular switch)	Nos.	8			
(e)	15/16 amps socket (For converting existing P/T socket into modular socket)	Nos.	8			
10	Supplying and fixing following size/ modules, GI box along with modular base & cover plate for modular switches in recess etc as required (M.R.)					
	(a) 3 modules	Nos.	4			
	(b) 4 modules	Nos.	8			
	(c) 6-8 modules	Nos.	8			
11	Supply & Installation of SITC of 4 way SPN type Distribution Board for Raw power, with 32 Amp 2 pole MCB ready to use, Including all necessary hardwares & accessories complete, material and labour (In every hall for UPS) (M.R)	Nos	4			

LAN CABLING

1	S/laying Cat 6E cable for Computer plugs (M.R)	Meter	2000			
2	S/F Connecting cable for Speakers (M.R)	Meter	102			

3	S/F Cat 6E I/O single port modular jack with IO Boxes on one sides (M.R)	Nos.	102			
4	S/F cat 6 Patch cords 4 pair RJ 45 compatible (Mounting cords) –1 mtr length (M.R)	Nos.	102			
5	S/F cat 6 Patch cords 4 pair RJ 45 compatible (Mounting cords) –2 mtr length (M.R)	Nos.	102			
6	S/F24 Port Patch panel (M.R)	Nos.	6			
7	Testing and tagging of Network points with numbering and ferrules (M.R)	Nos.	102			
8	S/F 24 Port Gigabit switch, Managed (RJ-45 compatible connectors/LAN Base Image) (M.R)	Nos.	6			
9	S/F 6U Wall mount rack with glass door, lock and key, powerstrip with 5/6A sockets, 1 cable manager, 1 fan and mounting hardware etc as reqd (M.R).	Nos.	2			
10	S/F 9U Wall mount rack with glass door, lock and key, powerstrip with 5/6A sockets, 1 cable manager, 1 fan and mounting hardware etc as reqd. (M.R)	Nos.	3			
11	Certification and documentation of networking system ,if required	Job	1			
TOTAL 'B' (Rs.)						
GROSS TOTAL COST (A+B) (Rs.)						

We agree to execute the works in accordance with the approved drawings and technical specifications at percentage above/below the estimated rates, i.e., for a total contract price of Rs.(amount in figures) (Rs. amount in words).

Signature of Contractor